

# DIAMOND DRILLHOLE LOCATION PLAN MAP

Western Area  
September 7, 2011

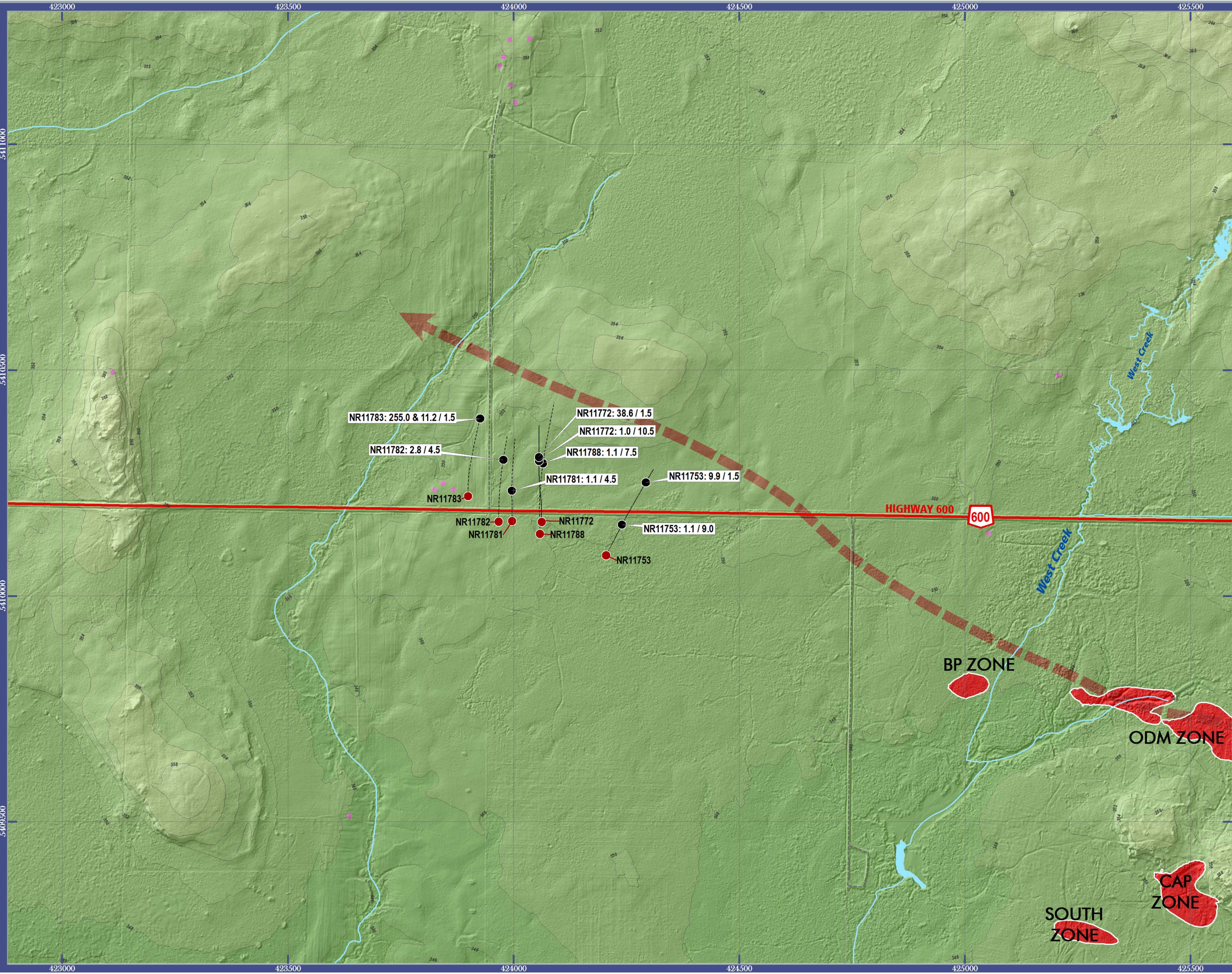

NR11783: 255.0 & 11.2 / 1.5  
 NR11782: 2.8 / 4.5  
 NR11783  
 NR11782  
 NR11781  
 NR11772  
 NR11788  
 NR11753  
 NR11772: 38.6 / 1.5  
 NR11772: 1.0 / 10.5  
 NR11788: 1.1 / 7.5  
 NR11781: 1.1 / 4.5  
 NR11753: 9.9 / 1.5  
 NR11753: 1.1 / 9.0

- New Diamond Drillhole (Gold and Silver Weighted Average)
- Drillhole Collar Location
- Drillhole Tracer
- Zone (Au, Ag)
- Zone (Ni, Cu, Pge)
- Magnetic Trend Line (Interpreted)

Label Composition  
**29.0 & 12.0 / 4.5**  
 = 29.0 g/t Au & 12.0 g/t Ag / 4.5 metres

- Building Location
- Arterial Road
- Local Road, Street
- Resource, Recreation Road
- Other Road Segment (MNR)
- Interpreted Road / Trail
- Waterbody
- Watercourse
- Contour (2m Interval)

332 Elevation (Metres ASL) 410

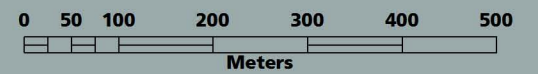

Copyright © Rainy River Resources Ltd. 2011



BP ZONE  
 ODM ZONE  
 SOUTH ZONE  
 CAP ZONE